



**REPUBLIC OF NAURU**  
**GOVERNMENT GAZETTE**  
**Published by Authority**

---

No. 95

26th November 1997

Nauru

---

G.N. No. 455 /1997

**CERTIFICATION OF ACT**

It is notified for general information that the Speaker certified the following Act which had been passed by Parliament and presented to him for his Certificate:

<b><u>NO. OF ACT</u></b>	<b><u>TITLE</u></b>	<b><u>DATE CERTIFIED</u></b>
No. 19 of 1997	Nauru Phosphate Royalties Trust (Amendment) Act 1997	21st November, 1997

DATED this twenty fifth day of November, One thousand nine hundred and ninety-seven

**F. CAIN**  
**CLERK OF PARLIAMENT**

---

No. 95 26th November 1997 Nauru

G.N. No. 456 /1997

**ENGAGEMENT TO MARRY**

NAME OF PARTIES: **CARISON BRUNO HARTMAN** of Anabar District and  
**GABRISSA SHIRANI GIOURA** of Nibok District.

DATE OF ENGAGEMENT: 17th November, 1997

**VASSAL A. GADOENGIN**  
**MINISTER IN CHARGE**

NAME OF PARTIES: **TIVANGA TEERUA** from Kiribati and  
**DERESA TOM** of Nibok District.

DATE OF ENGAGEMENT: 26th November, 1997

**VINSON DETENAMO**  
**MINISTER IN CHARGE**

G.N.No. 457 /1997

**BIRTHS, DEATHS AND MARRIAGES**  
**ORDINANCE 1957 - 1967**

Births, Deaths and Marriages registered the week ended 21st November, 1997, were:-

**BIRTHS**

**1. NAURUAN:**

<b><u>NAME</u></b>	<b><u>DATE OF BIRTH</u></b>	<b><u>SEX</u></b>	<b><u>TRIBE</u></b>	<b><u>REG'D DISTRICT</u></b>	<b><u>MOTHER'S NAME</u></b>
Jim-Dunn Deradab	04/11/96	M	Eamwit	Baitsi	Indira Dekarube
Javin	05/06/97	M	Iruwa	Boe	Fianga Kamtaura
Vicka Victoria Brigette Aisha Lucia Lilisani	12/06/97	F	Eamwitmwit	Yaren	Sophia Dageago
Maggie-Mae Margie Michola Mabel Eiraginugo Elika Dykina Deimica Antasha Anastacia Zenaris Zanjriella Olannyko Ojean Aecana Bonnie - Tyler Baby Janessa Thalia - Acacia Mercy X-Tina Sarki Roseann Selina	17/09/97	F	Eamwitmwit	Boe	Mabel Depoudu
Michelle Stephanie Sweet - Rose Eab	14/08/97	F	Iruwa	Meneng	Rasella Bagaga
Anthony Cooper Dominum Hilson Hans	25/08/97	M	Eamwit	Nibok	Hilda Demingauwe
Joette Xena Pridika Rae Mysumo Tasha Noni	21/10/97	F	Emea	Anetan	Raelene Ika
Bianca Shoshana Diana Kimberly Ronna	10/11/97	F	Eoaru	Anabar	Rosella Dageago

No. 95

26th November 1997

Nauru

G.N. No. 457 /1997 (cont'd)

**2. O.P.I.:**

<u>NAME</u>	<u>DATE OF BIRTH</u>	<u>SEX</u>	<u>RESIDENCE</u>
Buriti MARCONI	08/10/97	F	NPC Location
Tumera TEBURABURA	28/10/97	M	NPC Location
Merilyn TOKANNATA	06/11/97	F	NPC Location

**3. CHINESE:** - NIL -

**DEATHS**

**1. NAURUAN**

<u>NAME</u>	<u>DATE OF DEATH</u>	<u>SEX</u>	<u>AGE</u>	<u>REG'D DISTRICT</u>	<u>TRIBE</u>
Einana GADEOWA	12/11/97	F	83yrs	Baitsi	Eamwitmwit
Paul TATUM	13/11/97	M	44yrs	Uaboe	Deiboe
Josephine TAUNTEANG	15/11/97	F	37yrs	Meneng	Eamwitmwit

**2. O.P.I.:**

<u>NAME</u>	<u>DATE OF DEATH</u>	<u>SEX</u>	<u>NPC LOCATION</u>
Toora TEBOTU	23/11/97	M	NPC Location

**3. CHINESE:** - NIL -

**MARRIAGES**

FRANKIE AMRAM of Boe District and CHRISTINA ISABELLA GIOUBA of Yaren District on the 14th November, 1997, by Fr. Karl-Maria Brand, at the Mary, Queen of the World Church, Yaren District, Nauru.

GRAHAM B. BAGUGA of Meneng District and SUSAN KAKIAUEA also of Meneng District on the 16th November, 1997, by Rev. Labi D. Harris, at the Nauru Independent Church, Nauru.

M.B. CAIN  
DEPUTY REGISTRAR,  
BIRTHS, DEATHS AND MARRIAGES

**LAND DETERMINATION**

The Nauru Lands committee hereby determinations the ownership of certain land or shares in land as being that shown hereunder

<u>DISTRICT</u>	<u>PORT. NO.</u>	<u>TYPE OF LAND</u>	<u>NAME OF LAND</u>	<u>REFERENCE</u>	<u>FORMER OWNER</u>	<u>SHARE</u>	<u>PRESENT OWNERS</u>	<u>SHARE</u>	
Menen	417	p.l.	Atebawo	Land Reg. Book 1928 page 74.	Buredauw (dec'd) Eibuadi (dec'd)	1/2 1/2	Etto Aingimea	1/4	
							Tui Stephen	1/56	
							Nakori Teboua	1/56	
							Fredrick Teboua	1/56	
							Mathew Teboua	1/56	
							Onorio Teboua	1/56	
							Iba Hiram	1/56	
							Joanna Teboua	1/56	
							Elnora Watkins	1/56	
							Shirley Hovendene	1/56	
							Marlaine Akibwib	1/56	
							John Agege	1/56	
							Seymour Jonathan(LTO)	1/56	
							Bredauw Kabokia (LTO)	1/112	
							Teboua Jnr. Kabokia (LTO)	1/112	
							Onorio.T. T/ee	(Lisa Teboua)	1/112
								(Lovey Adam)	1/112
								Eiriki Diema	1/60
								Iyiminod Akua	1/60
								Ranin Akua	1/240
								Bryony Akua	1/240
								Livelma Akua	1/240
								Romulo Akua	1/240
								Elmina Ten Tiwae	1/240
								Raboe Roland	1/240
								Belsina Tamakin	1/240
								Nathan Aiyunge	1/240
	Russell Aiyunge	1/420							
	Roch Aiyunge	1/420							
	Loretta Degia	1/420							
	Yvonne Ika	1/420							
	Maureen Gabouwa	1/420							
	Nathan Aiyunge	1/420							
	Mongoria Tom (LTO)	1/420							

G.N.No. 458 /1997 (cont'd)

Saul Namoduk	1/7200
Gonzaga Namoduk (LTO)	1/7200
Rose-in Maro Deiranauw	1/180
Dagausi Deiranauw (LTO)	1/180
Dituweb Dowadi	1/20
Marie Kingrae	1/40
Mary Bill	1/40
Louise Akiri	1/45
Damien Menu	1/255
Dominic Menu	1/255
Mark Menu	1/255
Nathan Menu	1/255
Mary Anne Menu	1/255
Carren Satto	1/255
Baron Waqa	1/255
Micha Waqa	1/255
Luke Waqa	1/255
Irving Harris	1/255
Auweiyeda Star	1/300
Lantok Ephraim	1/300
Frederick Ricky Star	1/300
John Timouw Star	1/300
Lisera Agir	1/300
Eria Adam	1/300
Bonnie Temaki	1/300
Eidemoatena Temaki	1/300
Bwido Adam	1/150
Joanne E. Aubiat	1/40
Ben Ali Aubiat	1/40
Arangadoa Aubiat	1/40
Debeto Reiyetsi	1/160
Camelia Samson	1/160
Nei Retta Kingrae (LTO)	1/160
Rineidi Selo	1/800
Ingram Selo	1/800
Tonto Selo	1/800
Akogog Selo	1/800
Kerrylene Akubor	1/800

NOTE: Those who disagree with the above Land Determination may appeal to the Supreme Court Registry within 21 days of the publication of this Government Gazette No

LESLIE ADAM  
CHAIRMAN  
LANDS COMMITTEE

No.95

26th November 1997

Nauru

G.N.No. 458 /1997 (cont'd)

	Catherine Aremwa	1/480
	Narietta Harris	1/480
	Josephine Akubor	1/480
	Patricia Detenamo	1/480
	Lucy Detabouw	1/480
	Joseph Dediya	1/480
	Francis Dediya	1/480
Narietta H.	(Zarina Dediya	1/1920
Josephine A.	(Deliah Dediya	1/1920
Catherine A.	(Della Dediya	1/1920
Patricia D.	(Dante Dediya	1/1920
T/ee		
	Temaungeiyeda Tannang	1/90
	Eidurubwagago Adam	1/90
	Eirubidak Iga	1/90
	Bruce Amandus (LTO)	1/90
	Nei Lopa Hedmon (LTO)	1/90
	Sally Deiranauw (LTO)	1/90
	Tania Moses	1/720
	Lucas Hedmon	1/720
	Lucia Adam	1/720
	Juliana Hedmon	1/720
	Virginia Tannang	1/720
	Pelsina Daniel	1/720
	Emerien Quadina	1/720
	Liana Apadinuwe	1/720
	Elizabeth Dekarube	1/720
	Mary Appi	1/720
	Isobel Gaiyabu	1/720
	Klem Gadaraoa	1/720
	Myrle Tom	1/720
	Roslie Gadaraoa	1/720
	Chrestina Gadaraoa	1/720
	Catherina Namoduk	1/7200
	Francine Namoduk	1/7200
	Inatio Namoduk	1/7200
	Jana Namoduk	1/7200
	Kiriwanton Namoduk	1/7200
	Krista Namoduk	1/7200
	Peter Namoduk	1/7200
	Rinna Namoduk	1/7200

No.95

26th November 1997

Nauru

G.N.No. 459 /1997 (cont'd)

Frank Roland	1/112
Irene Roland	1/112
Ken Roland	1/112
Melvin Roland	1/112
Michael Roland	1/112
Vaughn Roland	1/112
Wendy Roland	1/112
Lenice Adeang	1/112
Jillian Bam	1/112
Valda Jeremiah	1/112
Alamanda Roland	1/112
Farrah Roland	1/112
Esther Roland (LTO)	1/112
Elaine Bailey	1/112

NOTE: Those who disagree with the above Land Determination may appeal to the Supreme Court Registry within 21 days of the publication of this Government Gazette No

**LESLIE ADAM**  
**CHAIRMAN**

---

**LAND DETERMINATION**

The Nauru Lands Committe hereby determines the ownership of certain land or share in land as being that shown hereunder:-

<u>DISTRICT</u>	<u>PORT. NO.</u>	<u>TYPE OF LAND</u>	<u>NAME OF LAND</u>	<u>REFERENCE</u>	<u>FORMER OWNER</u>	<u>SHARE</u>	<u>PRESENT OWNERS</u>	<u>SHARE</u>
Menen	419	p.l.	Aiyuae	Land Reg.Book1928 Page 69.	Helena Star (dec'd)	1/4	Tamaiti W. Star	1/32
					Lily Joseph (dec'd)	1/4	Eli Star	1/32
					Lina Emiu (dec'd)	1/4	Percy Star	1/32
					Augusta Tetiboua (dec'd)	1/4	Gorodag Star	1/32
							Eidowedo Estate-Tamaiti T/ee	1/32
							August Grundler	1/256
							Barry Grundler	1/256
							Leonardo Grundler	1/256
							Trapian Grundler	1/256
							Samuel Grundler	1/256
							Cecilia Alefaio	1/256
							Rosa Itsimaera	1/256
							Lisera Chong Gum	1/256
							Brian Phillip	1/224
							Clinton Phillip	1/224
							John Phillip	1/224
							Jonathan Phillip	1/224
							Rona Bop	1/224
							Sandra Phillip	1/224
							Vida Dick	1/224
							Auweiyeda Star	1/160
							Dira Ephraim	1/160
							Tsimouw Star	1/160
							Lisera Agir	1/160
							Ricky Star	1/160
							Ekaura Joseph	1/12
							Ekauwe Joseph	1/12
							Eabweo Joseph (LTO)	1/12
		Kelly Emiu	1/4					
		Arthur Redfern	1/24					
		Mike Redfern	1/24					
		Bereka Tanaera	1/24					



DISTRICT OF MENENG

SCALE 1:1000



" KETAWIYI "

365

Gamanoa Joram. & Co.

" KETAWIYI "

388

Theodore Moses. & Co.

DISTRICT  
DISTRICT

419

Undetermined  
Land

" KARAWINURORO "

415

Enotue Batsiua. & Co.

Undetermined  
Land

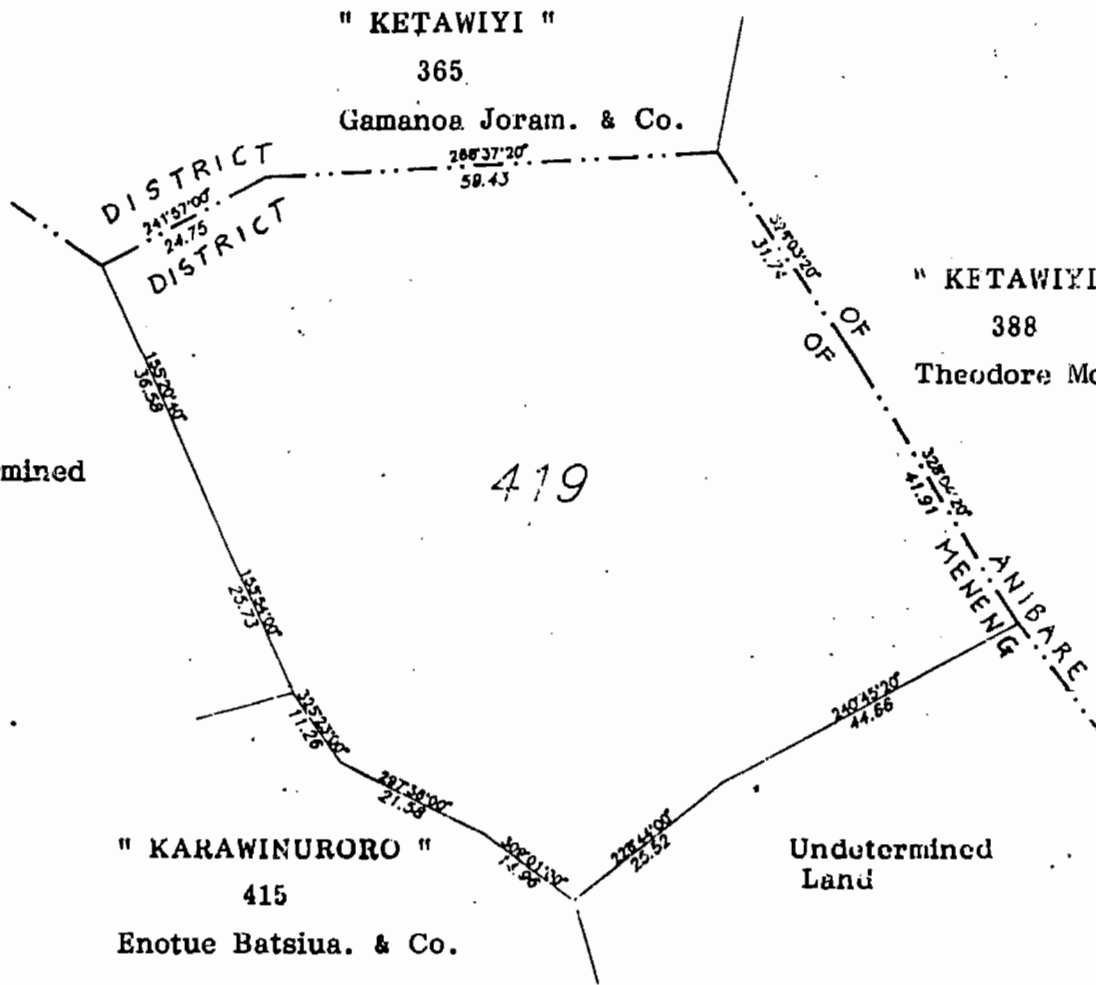

G. No. 460 / 1997.

DISTRICT OF MENENG

SCALE 1:1000

